



Zmaja od Bosne bb, Zenica  
Bosna i Hercegovina  
+387 32 441 200  
[www.itc.ba](http://www.itc.ba)

  
ITC  
METALOPRERADA

*Ljepota mogućnosti - Beauty of possibility*







○ nama  
**Profitni centar Metaloprerađ**

About Us  
**Profit center Metal processing**

Od 2000. godine, ITC je uspostavio svoje prve proizvodne kapacitete iz oblasti metaloprerađe, nakon čega je započeo s proizvodnjom metalnih konstrukcija, transportnih sistema za industriju i rudarske podgrade u podzemnoj eksploataciji. Danas je ITC osposobljen za izvođenje složenih poslova iz oblasti proizvodnje industrijskih postrojenja uključujući i montaže čeličnih konstrukcija i različite vrste remonta industrijskih postrojenja. ITC Zenica polaže veliku pažnju u edukacij i osposobljavanje svojih zaposlenika, a sve sa ciljem kako se u budućnosti može uspješno nositi sa novim izazovima u svrhu implementacije misije Preduzeća i stjecanja povjerenja kupca u kvalitete proizvoda i usluge koju garantira ITC Zenica.

Since 2000 , ITC has established its first production capacities in metal processing, and after that it began with the production of metal structures, transport systems for industry, process equipment and mining equipment in the underground exploitation. ITC has the capability to perform complex tasks in the field of manufacturing and erection of steel structures and various types of maintenance in industrial plants. ITC Zenica pays great attention to education and training of their employees. Our aim is that in the future we successfully deal with new challenges during implementation of company mission to acquire customer confidence in the quality of products and services guaranteed by ITC Zenica.

## MISIJA

Projektovanjem, izradom i montažom čeličnih konstrukcija te proizvodnjom i održavanjem opreme, omogućavamo svojim kupcima u industriji da obezbijede pouzdanost i sigurnost funkcionisanja proizvodnog procesa i time unaprijede svoju ekonomičnost poslovanja. Fokusirani smo na kvalitet izvedenih radova kao i na očuvanju zdravlja i zaštiti radnika tokom izvođenja radova.

## MISSION

Design, manufacture and installation of steel structures as well as production and maintenance of the equipment, enable our customers in the industry to provide reliability and safety functioning of the production process and thereby improving their business economy. We are focused on quality of performed works and to preserve health and protection of our employees during the execution of works.





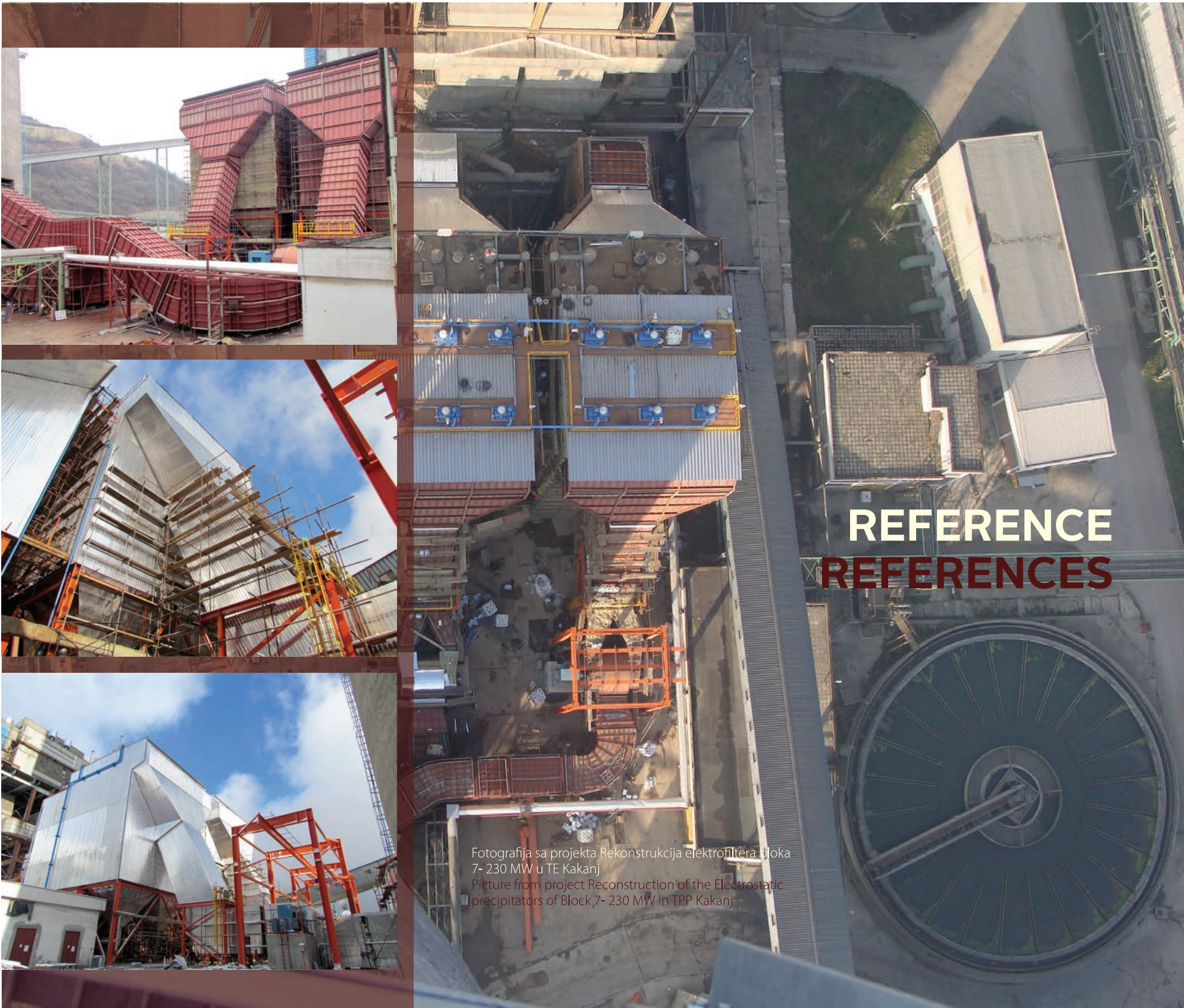

# REFERENCE REFERENCES

Fotografija sa projekta Rekonstrukcija elektrofiltera bloka 7- 230 MW u TE Kakanj  
Picture from project Reconstruction of the Electrostatic precipitators of Block 7- 230 MW in TPP Kakanj



Revitalizacija krana MIAG 1 i  
transportne linije uglja

Revitalization of crane MIAG 1 and  
transport lines of coal

**Natron-Hayat Maglaj**

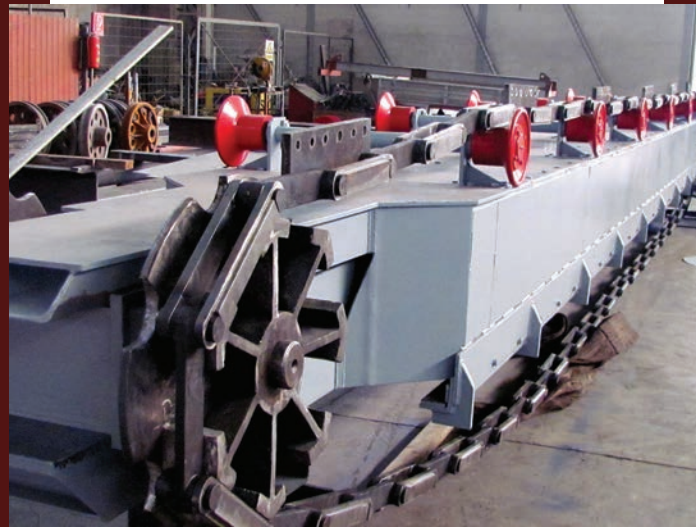

Izrada i montaža čelične konstrukcije sa  
anti-korozivnom zaštitom

Design and installation of steel construction  
with corrosion protection

**House Milos d.o.o. Ilidža**

Izrada i montaža silosa za cement i  
kvarcni pijesak

Design and installation of silos for  
cement and quartz sand

**Caparol Sarajevo**





Izgradnja naplatne rampe u mjestu Lučani, Kakanj, Zenica u sklopu izgradnje autoputa na koridoru Vc

Construction of the toll gate in Lučani, Kakanj, Zenica within the construction of highways on Corridor Vc

**JP Autoceste BiH**

Izmjenjivač toplote

Heat exchanger

**Univerzitetski klinički centar  
Sarajevo**



Izrada i montaža cjevovoda za otprašivanje u pogonu Visoka peč i Aglomeracija.

Design and installation of pipelines for dedusting in the blast furnace facility and agglomeration.

**Arcelor Mittal Zenica  
(TSP Grude)**

Izrada i isporuka transportnih valjaka

Manufacture and delivery of  
conveyor rollers

**JP Elektroprivreda BH**



Projektovanje, izrada i montaža  
transportera - II faza VOŠIP

Design, manufacture and assembly of  
conveyor - Phase II VOŠIP

**JP EP BiH, TE Kakanj**

Kiper stanica

Kiper station

**JP EP BiH TE Kakanj**





Izrada i montaža čelične konstrukcije, krovopokrivački, limarski i bravarski radovi na fiskulturnoj Sali, Osnovna škola Behaudin Selmanović Brijesće, Sarajevo

Design and installation of steel structures, roofing, tinsmithing and mechanical works at the gym, Primary school Behaudin Selmanović Brijesće, Sarajevo



Kontinuirana optimizacija mlinskih linija bloka 5,6 i 7

Continuous optimization of the mill line blocks 5.6 and 7

**TE Kakanj**

Zamjena čelične konstrukcije obrtača vagona br. 2

Replacing of steel structure of the wagon rotator no. 2

**TE Tuzla**





EN ISO  
9001

EN ISO  
14001

EN ISO  
3834-2

EN ISO  
1090

### Šta možemo:

Sve vrste bravarsko-zavarivackih radova

Strojna obrada sa CNC obradnim centrima

Usluge rezanja plazmom i gasom

Procesna oprema

Sve vrste transportnih sistema

2D projektovanje i 3D modeliranje

### What we can do:

All types of mechanical and welding works

Machine processing at CNC machining  
centers

Plasma cutting and gas cutting services

Processing equipment

All kinds of transportation systems

2D design and 3D modeling

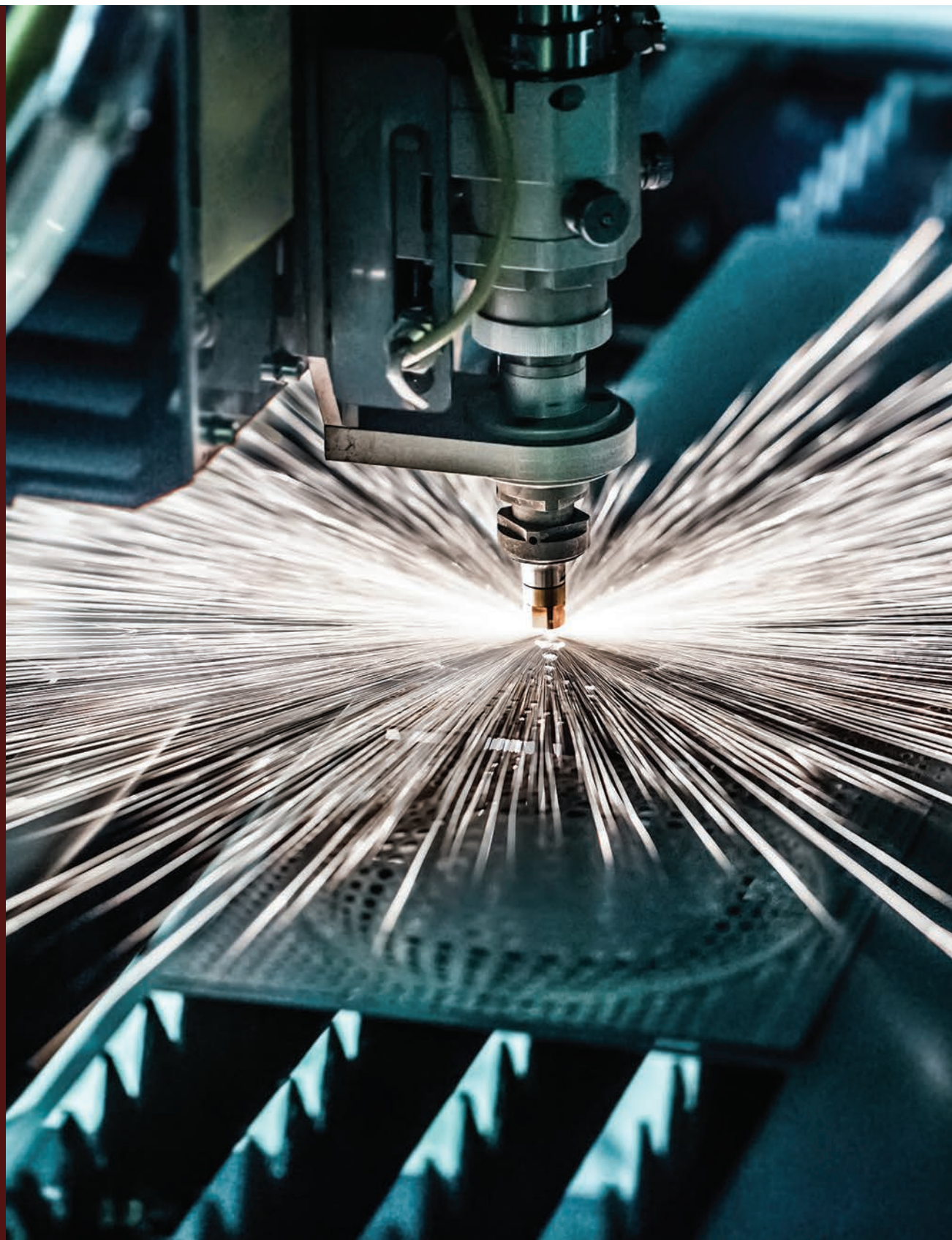





1.CNC glodalica HURON  
Maksimalna dimenzija obrade  
2000x1200x980 mm  
CNC milling machine HURON  
(max. Size 1200 x 980 x 2000 mm)



2.Rolo-valc mašina za kružno savijanje  
do (15 mm debljine, na dužini od 3000  
mm)  
CNC roll machine (bending sheets up to  
15 mm in length 3000 mm)



3.CNC tokarski stroj  
Maksimalna dimenzija obrade fi 320  
mm dužine 450 mm  
CNC lathe mashine Pittler (max. size  
of piece , dia. Ø320 mm, l = 450 mm)



4.CNC makaze za sječenje limova (do 16  
mm debljine, na dužini od 3000 mm)  
CNC sheet cutting shears (max. sheet  
thickness of 16 mm, a length of 3000 mm)



5.CNC abkant hidraulična presa (do 15  
mm debljine, na dužini od 3000 mm)  
CNC brake press 125 t (max. sheet  
metal bending up to 15 mm thick, the  
length of 3000 mm)



6.CNC plazma i plinsko sječenje limova  
Maksimalna dimenzija table  
100x2000x12000 mm  
CNC plasma and gas cutting mashine  
(table to 100x2000x12000 mm)



The image shows the interior of a tunnel under construction. The walls and ceiling are supported by a series of dark, curved steel arches. The floor is a rough, uneven surface. In the distance, a small red vehicle is visible. The lighting is dim, with a few bright spots from overhead lights.

## PODGRADE - STEEL ARCH SUPPORT

U sklopu proizvodnog programa PC Metaloprerade, preduzeće ITC d.o.o. ZENICA nudi čelične lučne podgrade, kao i spojni pribor za čelične lučne podgrade, koje imaju široku primjenu u izgradnji dugačkih rudničkih okna, te i u izgradnji tunela i galerija.

As part of the production program of metal processing sector, the company ITC doo ZENICA is offering a steel arch support, as well as fittings for steel arched supports, which are widely used in the construction of long mining shaft, as well as in the construction of tunnels and galleries.



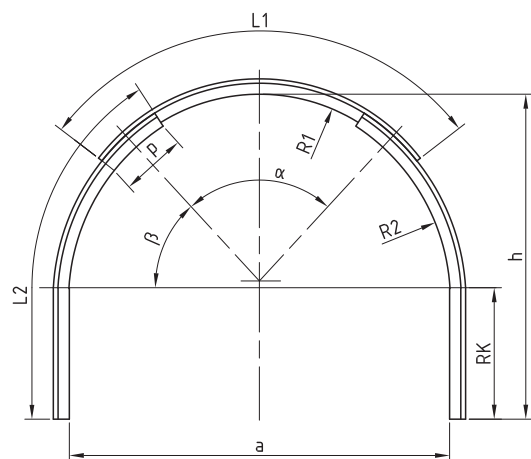

### Trodjelna popustljiva lučna podgrada sa ravnim završetkom bočnih segmenata

- Standardne dužine lukova 1,8 - 5,5 m
- Minimalni radijus zakrivljenja  $R=1000$  mm za profil TH 29  $R=1200$  mm za profil TH 34  $R=1600$  mm

### Three-part permissive arch support with flat-topped side segments

- Standard arc lengths from 1.8 to 5.5 m
- The minimum bend radius  $R = 1000$  mm
- Profile TH 29  $R = 1200$  mm
- Profile TH 34  $R = 1600$  mm

### Okrugla četverodjelna popustljiva podgrada

- Standardne dužine lukova 1,8 - 5,5 m
- Minimalni radijus savijanja  $R=1000$  mm za profil TH 29  $R=1200$  mm za profil TH 34  $R=1600$  mm

### Round four-part permissive arch support

- Standard arc lengths from 1.8 to 5.5 m
- The minimum bending radius  $R = 1000$  mm for profile TH 29  $R = 1200$  mm for profile TH 34  $R = 1600$  mm

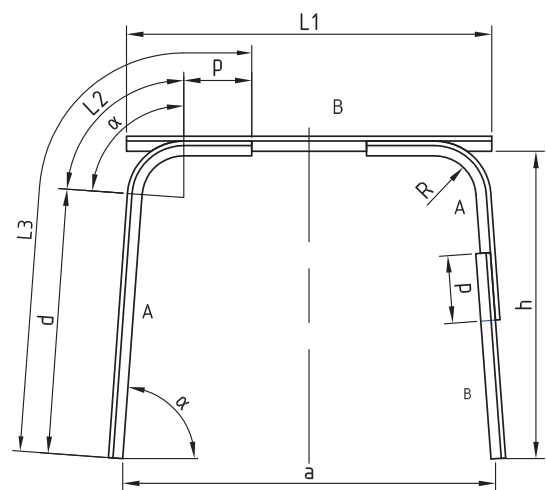
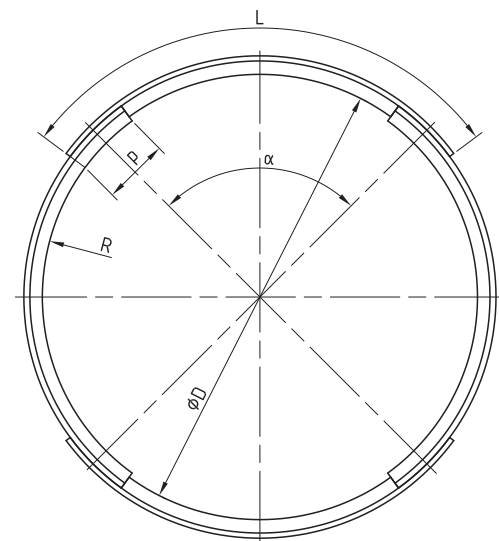

### Trapezna podgrada

Trapezne podgrade izradujemo od K21, K24, P28, TH29, isključivo u verziji sa normalnim savijanjem

- Standardne dužine lukova 0,7 - 4,0 m
- Radijusi savijanja: za profil K21 i K24  $R=200$  mm za profil P28 i TH29  $R=300$  mm

### The trapezoidal arch support

Trapezoidal arch support is made of K21, K24, Q28, TH29, only in a version with a normal bending

- By conventional arc lengths from 0.7 to 4.0 m
- Bending radius: For profile K21 and K24 of  $R = 200$  mm For profile P28 and TH29  $R = 300$  mm

### Četverodjelna popustljiva lučna podgrada sa oblim bočnim segmentima

- Standardne dužine lukova 1,8 - 5,5 m
- Minimalni radijus savijanja  $R=1000$  mm za profil TH 29  $R=1200$  mm za profil TH 34  $R=1600$  mm

### The four-part permissive arch support with rounded lateral segments

- Standard arc lengths from 1.8 to 5.5 m
- The minimum bending radius  $R = 1000$  mm
- Profile TH 29  $R = 1200$  mm
- Profile TH 34  $R = 1600$  mm

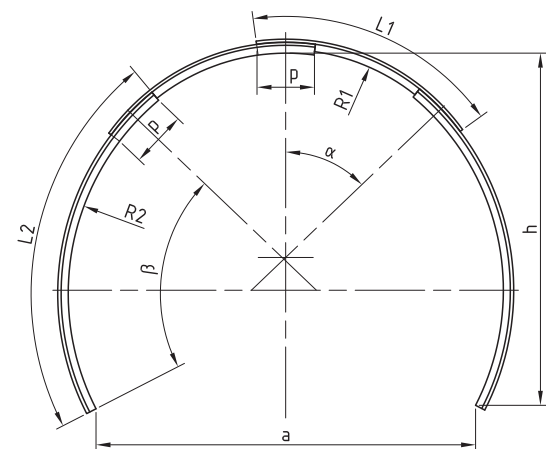



## Tipovi profila- Profile types

TIP PROFILA	G kg/m	S cm <sup>2</sup>	O mm	A1 mm	A2 mm	B mm	C mm	D mm	F mm	E1 mm	E2 mm	Jx cm <sup>2</sup>	Jy cm <sup>2</sup>	Wx cm <sup>2</sup>	Wy cm <sup>2</sup>
<b>P28</b>	27,94	35,60	621,45	148,00	109,00	127,50	14,50	35,00	28,50	63,00	64,48	395,83	698,26	92,41	94,36
<b>K21</b>	20,74	26,42	514,93	124,00	88,00	104,00	14,00	46,20	24,00	52,11	51,89	319,10	356,45	61,24	57,99
<b>K24</b>	23,67	30,15	521,63	124,70	88,00	107,00	17,00	46,20	27,00	51,18	53,82	372,37	404,49	69,19	65,47
<b>TH16,5</b>	16,70	2,26	444,52	106,00	80,00	90,00	13,00	31,00	22,50	44,25	45,75	173,00	227,00	38,00	43,00
<b>TH21</b>	20,92	26,65	539,30	127,00	96,00	108,00	12,00	35,00	27,00	54,00	54,00	32,00	410,00	60,00	64,00
<b>TH29</b>	29,00	37,00	620,11	150,50	116,50	124,00	16,00	44,00	28,50	58,20	65,80	616,00	775,00	94,00	103,00
<b>TH34</b>	33,90	43,10	697,13	171,00	128,50	136,60	15,50	50,50	30,00	68,80	69,70	892,00	1205,00	128,00	141,00
<b>TH36</b>	35,90	45,70	700,08	171,00	128,50	138,00	17,00	50,50	31,30	68,80	71,20	969,00	1265,00	136,00	145,00

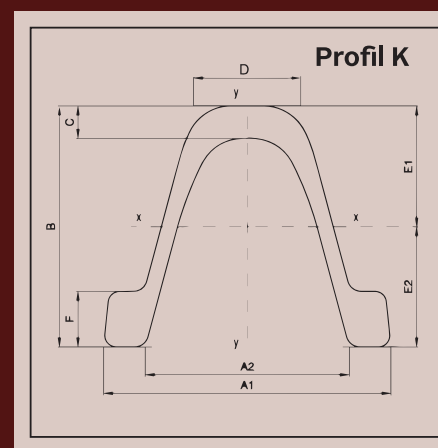
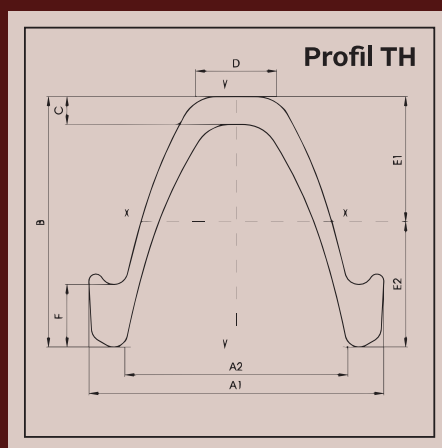

## Hemijski sastav čelika za profile - Chemical composition of steel profile

Oznaka čelika	ČSN, EN, DIN	C (%)	Mn (%)	Si (%)	S max (%)	P max (%)	Al max (%)	N max
11500,0	411500			0,045	0,045			0,09
E 295	EN 10025-A1			0,045	0,045			0,09
12130		0,28-0,35	1,00-1,30	0,040	0,040		0,35-0,60	
31 Mn 4	21544	0,32-0,36	0,80-1,10	0,045	0,045	0,020	0,20-0,50	

## Mehanička svojstva čelika za profile - Mechanical properties of steel profiles

Oznaka čelika Steel type	Standard	EN/DIN standard	Re	Rm	As	Profili koji se izrađuju od navedenog čelika The profiles that are manufactured from mentioned steel
11500,0	ČSN 411500		295	470-610	20	K21, K24, P28
E 295		EN 10025-A1	295	470-610	20	K21, K24, P28
12130	KN 412130		510	690-930	15	K24
31 Mn 4	KN 412149	DIN 21544	350	550 min	18	TH16,5, TH21, YH29, TH34, TH36





ITC

*Ljubota mogućnosti*